

[Measurement Methods]

Leave "LuciPac Pen-AQUA" at room temperature until they have reached room temperature.

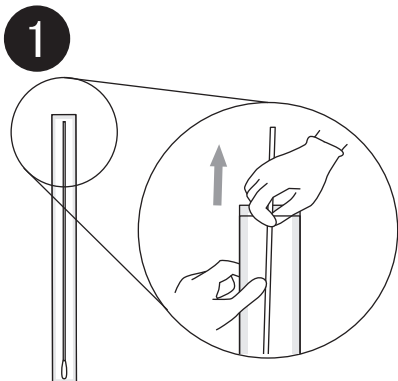

Wear lab gloves to prevent contamination and take out the long stem swab carefully so as to not to touch the parts as this may affect the cleanliness level.

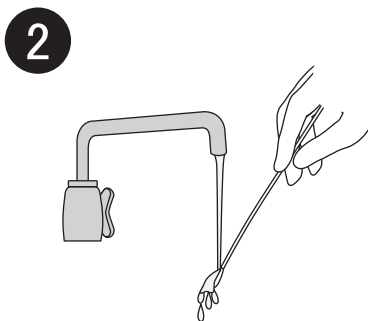

If running the measurement test on a dry surface, first moisten the cotton bud or the test subject with tap water*4). Please avoid using saline solution instead of water.

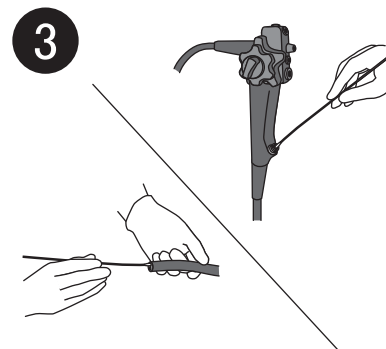

Handle the long stem swab with care so as to not to touch the parts as this may affect the cleanliness level. Insert the long stem swab in the canalicular object to be tested, and wipe it off as long as the length of the long stem swab reaches, and pull the swab up slowly.

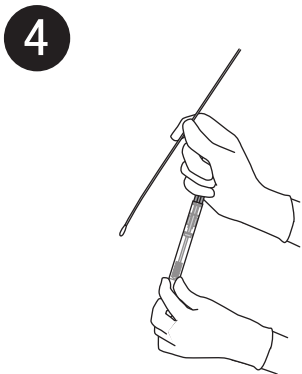

Hold the long stem swab at 12 cm or 13 cm distant point from the cotton bud, and remove the sampling stick from the main body (casing) of the LuciPac Pen-AQUA by your free fingers. Handle the sampling stick with care so as to not to touch the parts as this may affect the cleanliness level.

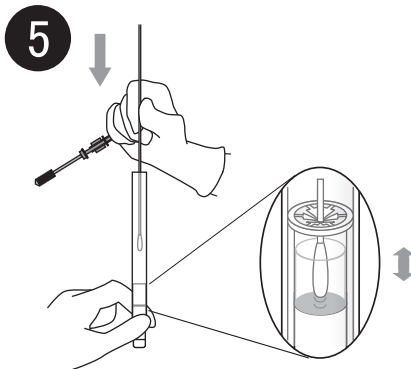

Insert the long stem swab in the main body (casing) of the LuciPac Pen-AQUA to push and break the center of the upper seal of the container. Be careful not to break bottom seal of the container for releasing reagent. Remove the long stem swab after thoroughly washing the cotton bud in the releasing reagent.

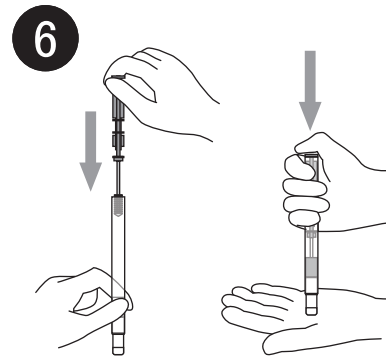

Return the sampling stick to the main body (casing) and push it all the way into the main body.

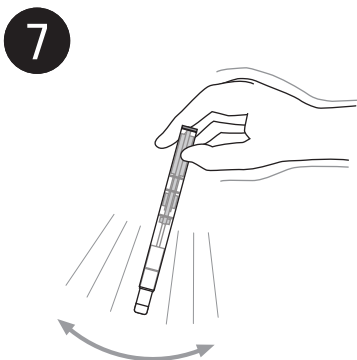

Hold firmly onto the LuciPac Pen-AQUA casing and shake it. Allow leftover luminescent reagent to thoroughly dissolve.



Insert the LuciPac Pen-AQUA into the Lumitester and close the Lumitester measurement chamber cover.



Press ENTER key. Measurement result is displayed after countdown.

*4) If the luminescence level of tap water shows high, we recommend you to let the water flow a few minutes and/or clean up the outlet of tap.